

MHV102 Human-Vehicle Discrimination Radar

User Guide

Type MHV102 high performance Discrimination Radar specialized for industrial door, garage door, old storage door, barrier gate and related products, which can separate the vehicle and pedestrian, also they can open separately related relay output according your requirement, meanwhile, they have recognition and filtering function for lateral moving vehicles or pedestrians.

Product preview



Product size

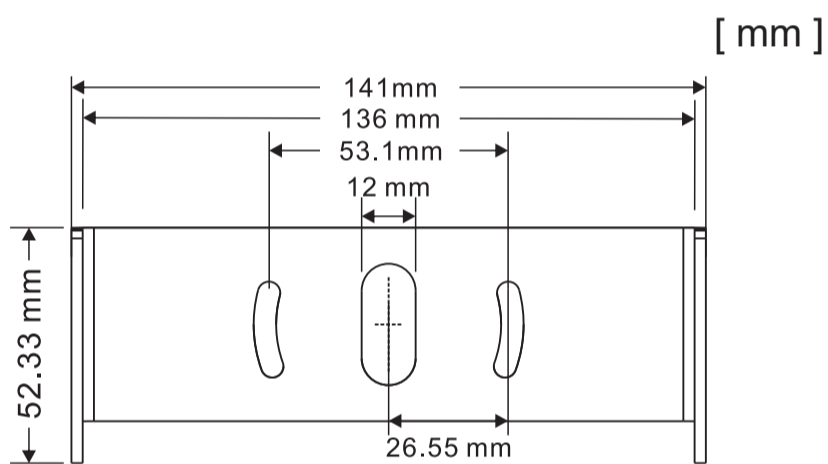

Wiring connection and installation



Note: Detecting people, red light on, detecting vehicle, green light on

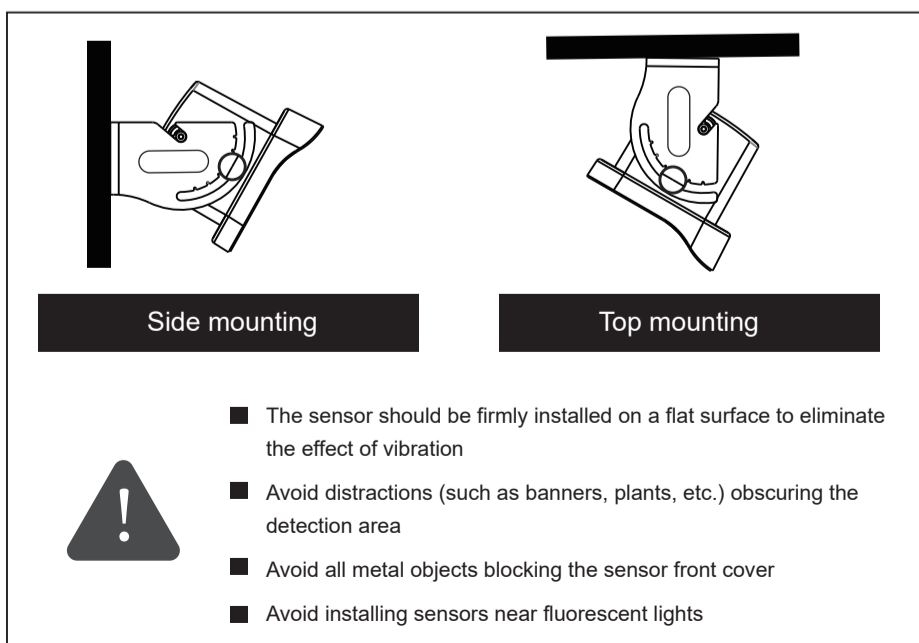

Technical Data

Application technology	Doppler radar
Emission frequency	24.125GHz
Emission power	<20dBm
Detection height	2.0m~9.0m
Adjustment angle	0°~ 180°
Detection speed	5cm/s ~ 25km/s
Detection area (30°)	3.0m*3.5m At 2m height 6.5m*8.5m At 9m height
Working voltage	12~36VADC
Working current	<100mA
Power supply frequency	50Hz
Temperature range	-30°C ~ +60°C
Relative humidity	0% - 95%, non-condensing
Protective registration	Ip65
Relay output	24VDC@1A 12VAC@0.5A
Appearance size (support included)	164mm x 111mm x 94.5mm
Cable length	7m
weight	650g

Data setting

Press the X and Y buttons simultaneously, you can enter the function settings

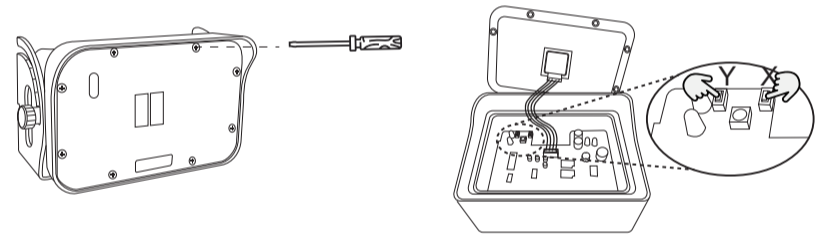

1. Remove the front cover panel and press the X and Y keys at the same time to enter the function Settings

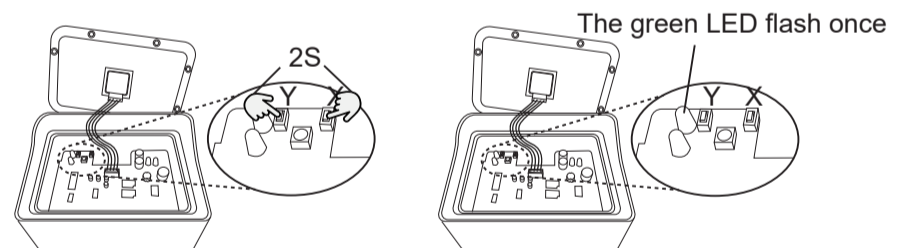

2. Press the X and Y buttons for 2S at the same time, the green indicator flashes once, and then release it to enter the basic function

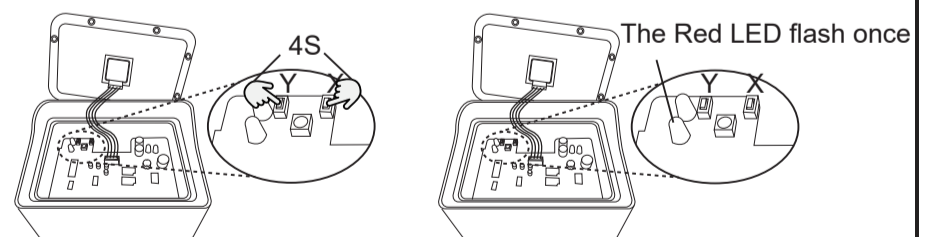

3. Simultaneously press the X and Y keys 4S, the red indicator flashes once, and then release to enter the depth function

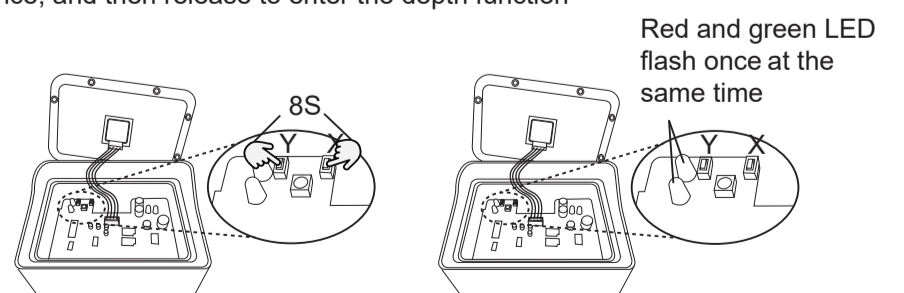

4. Press the X and Y keys at the same time 8S, red and green LED flash once at the same time, and then release to restore factory Settings

MHV102 Human-Vehicle Discrimination Radar

Data setting

Setting	unction key X, Corresponding green light the green light	Function No Corresponds to the timesr of green light flicker	Grade key Y, corresponding to red light	Function description and default Settings corresponding to times of flicker
Basic functions	Detection level	1	1-8	1.Standard speed,for all objects(pedestrians and vehicles) 2.Medium speed for all objects(pedestrians and vehicles) 3.High Speed for all objects(pedestrians and vehicles) 4.Detecting low speed movement for all objects(pedestrians and vehicles) 5. Standard Distinguish between pedestrians and vehicles 6.Medium speed Distinguish between pedestrians and vehicles 7.High speed detecting vehicles,not detecting pedestrians 8.Detecting low speed movement,Distinguish between pedestrians and vehicles Default setting:5
	Installation height	2	1-7	1: 2.0-3.0m 2: 3.0-4.0m 3: 4.0-5.0m 4: 5.0-6.0m 5: 6.0-7.0m 6: 7.0-8.0m 7: 8.0-9.0m Default setting:4
	Relay data setting	3	1-8	1.Standard industrial door,Distinguish between pedestrians and vehicles, different relay output 2.Standard industrial door,just detecting vehicles,Relay 2 output 3.Standard industrial door,just detecting pedestrians, Relay 1 output X:44.15cm Y:6.64cm 1output 4.Standard industrial door,pedestrians and vehicles,Relay 2 output 5.Standard industrial door,pedestrians and vehicle, different reply output 6.High speed industrial door,just detecting vehicles,Relay 2 output 7.High speed industrial door,detecting pedestrians and vehicles,Relay 2 output 8.High speed industrial door,pedestrians and vehicles,different relay output
	detecting area	4	1-9	1-3:small detection area 4-6: medium detection area 7-9, big detection area default setting:4-6
Depth function	Relay output time	1	1-5	1:0.2S 2: 0.5S 3: 1.0S 4;2.0S 5:5.0S default setting:4
	Directions recognition	2	1-3	1.Forward,movement close to radar 2.Backward,away from radar 3.Forward and backward default setting:1
	Lateral motion recognition	3	1-9	1:Close 2-3:Low 4-6: Medium 7-9:High defaulted settin
	Slow motion detection level	4	1-2	1:Close 2.Open defaulted setting:1
	Slow motion detection level	5	1-9	2-5:Lower the sensitivity 6-9:Higher sensitivity
	Slow motion detection level	6	1-9	1:Small detection area 9:Big detection area defaulted setting:1
	Anti-interference function	7	1-2	1:Shut down filter function 2:Activate filter function defaulted setting:1

Transform functions

Press X key,when press the key once,function value No will increase 1,once reach last function,the software will back to first function.

Transform level

Press Y key,when press once the key every time,the function value No will increase 1,once reach last level,the software will back to the first grade

Log put setting

Press X and Y key at the same time,you will log out from setting.

Work area display

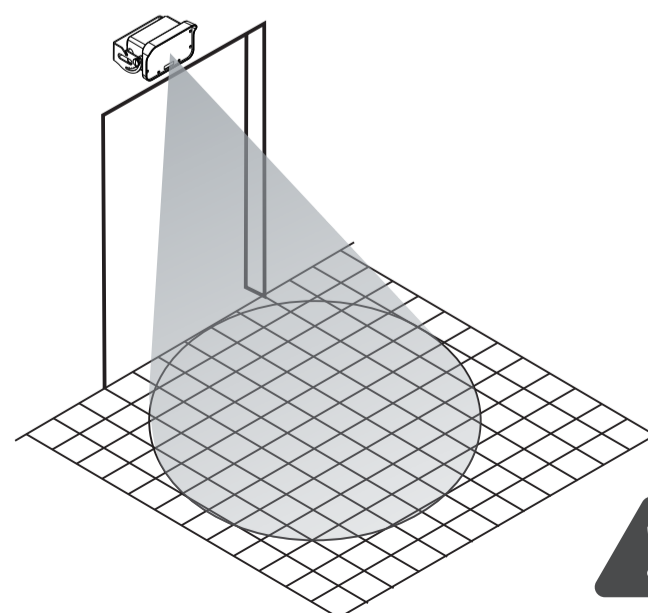

Remote can set parameters