

Manual

INFRARED SENSOR

MEGORAS MIR102

PHOTOGRAPH



SIZE AND COMPONENTS' NAME

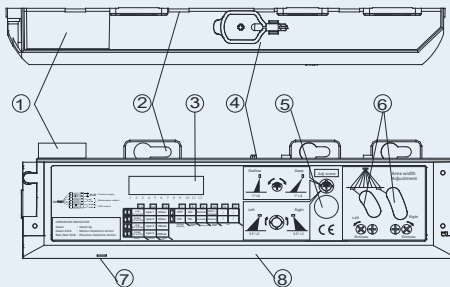
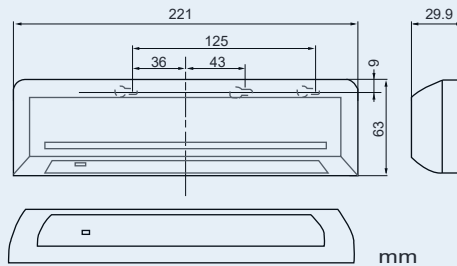

- 1: Connector
- 2: Mounting holes
- 3: Dipswitches
- 4: Area adjusting tool
- 5: Area adjustment screw
- 6: Width adjustment shutters
- 7: Operation indicator
- 8: Detection window

SPECIFICATIONS

Cover color type	Silver/Black
Mounting height	3.0m(910")Max.
Power supply	12 to 30VAC/DC
Current draw	160mA Max.(At 12VAC)
Operation indicator	Green: stand-by Yellow blink : Motion Detection Action Red /Red blink : Presence Detection Action
Output	Relay
Response time	<0.3sec.
Operating temperature	-20C to +55 C (-4F to +131F)
Weight	200g(7.1oz)

TERMINAL DETAILS

The cable is arranged to connect to the door controller properly as shown below.

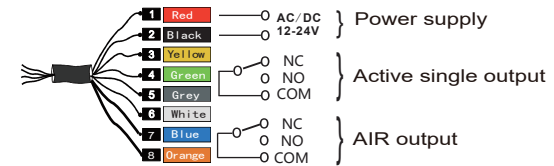

WARNING Danger of electric shock. Connect the cable when main power is turned OFF. When passing through the cable to the hole, make sure not to tear shield; otherwise it may cause electric shock or breakdown of sensor.

ADJUSTMENTS

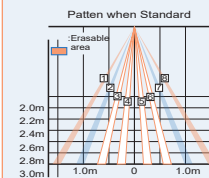
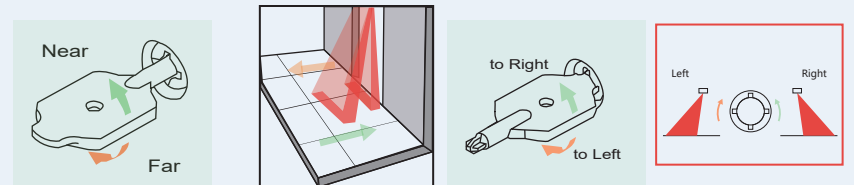

- Adjusting the Pattern Width
- Setting the width adjustment shutters

Opens All Areas	Eliminate [1][2]	Eliminate [7][8]	Eliminate [1][2][7][8]

Adjusting the width angle left or right: between 0° to 7° (3.5° per click)

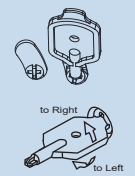

Manual

INFRARED SENSOR

MEGORAS MIR102

DETECTION AREA

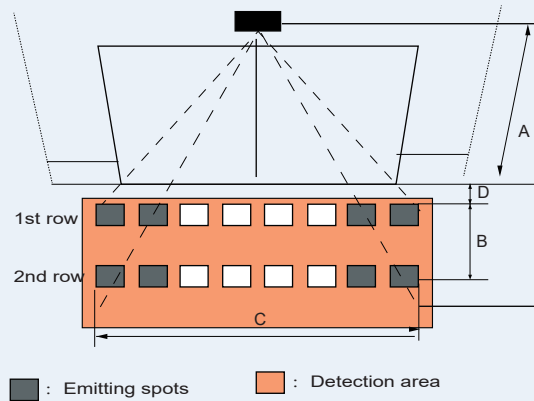

	2.00	2.20	2.50	2.70	3.00
A	2.00	2.20	2.50	2.70	3.00
B	0.69	0.76	0.87	0.93	1.05
C	2.10	2.30	2.60	2.80	3.10
D	0.16	0.18	0.20	0.22	0.25

[m]

- After adjustment, turn the power OFF and ON again, be sure to walk-test all of detection areas.
- *The values of the chart below is of the emitting spots, but not of the detection area.
- The actual detection area may become smaller depending on the ambient light and the colour/material of object and the floor as well as the entry speed of object.

DIPSWITCH SETTINGS

DIP SWITCH	DIP	SETTING				DETAILS
1	Sensitivity	Low	middle	high	super high	Set the sensitivity according to the mounting height. Values below dipswitches are reference only. Adjust the sensitivity according to your risk assessment.
2						
3	Frequency	Type 1	Type 2	Type 3	Type 4	When using more than two sensors close to each other, set the frequency different for each sensor.
4						
5	Presence timer	30sec	60sec	180sec	600sec	To enable the presence detection, do not enter the detection area for 10 seconds after setting the timer.
6						
7	Row function	2row	1row			
8	Null					
9	Mode selection	Normal	Immunity			Set the Dipswitch 9 to snow mode, if the sensor is used in a region with snow or a lot of insects.
10	Infrared output	Presence	Motion+Presence			Infrared sensor works as "Presence" or "Motion+Presence"
11	Null					
12	Null					